

# METRIC KEEPER ADP999

GLOBAL STANDARD COMPONENTS



Assembly

08/24/07

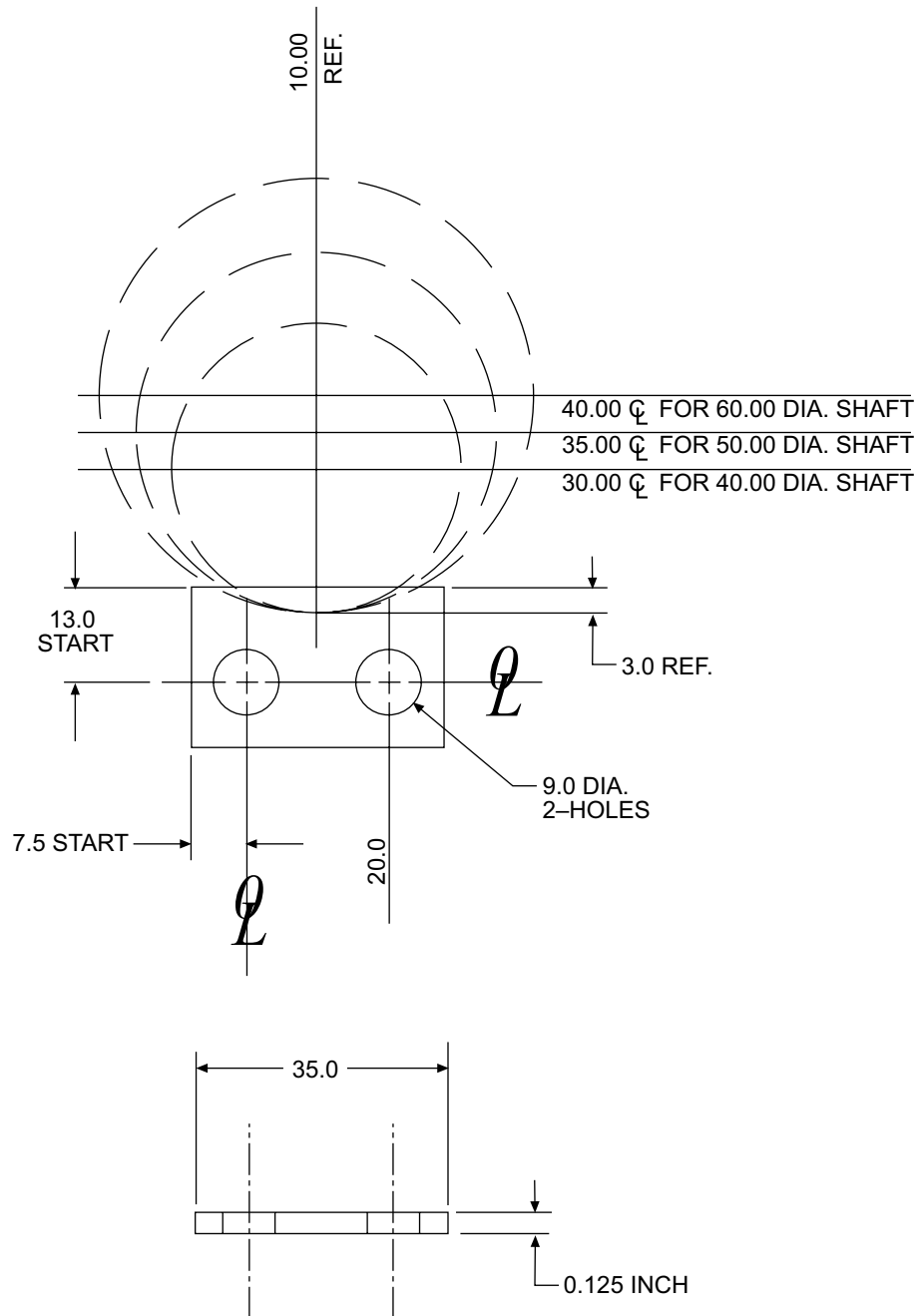

EXCEPT AS NOTED TOLERANCES SHALL BE:

- 1 PLACE MACHINING  $\pm 0.3$
- 1 PLACE FABRICATION  $\pm 1.5$
- 2 PLACE  $\pm 0.03$  GENERAL
- $\pm 0.03$  BETWEEN DOWELS
- $\pm 0.13$  TO SCREW HOLES

ALL DIMENSIONS METRIC UNLESS OTHERWISE NOTED.

STK: 1/8" X 7/8" X 35.0 MM LG. S.A.E.  
1018 C.R.S.

SEE PAGE B-1.1 FOR GLOBAL MATERIALS CHART

A

B

C